



# OVERWEIGHT AND OVERSIZE TRUCK PERMITTING ON LOCAL ROADWAYS



# LoadPass

PERMITS





# LoadPass Permits

---

A uniform system for the permitting of overweight and oversized loads on participating county, township, and city roadways.



# LoadPass Permit Counties

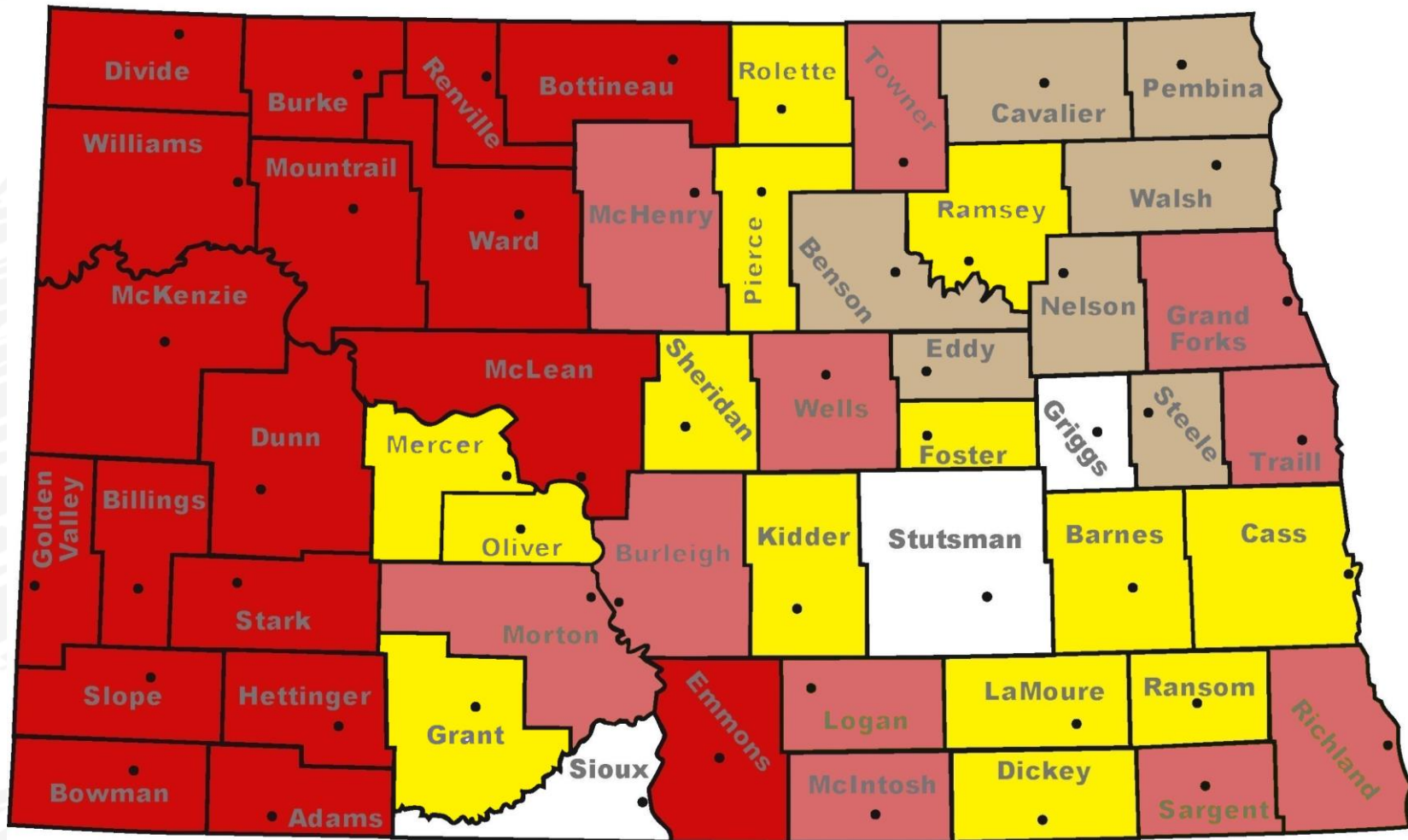



# Permit System History

---

- Permit System started in the mid-1980's by ND Association of Oil and Gas Producing Counties (now Western Dakota Energy Association) to track and monitor overweight (non-divisible loads) and over-dimension trucks on oil county roads.
- Began as Non-Uniform system – each county had different rules, regulations and fees
- Mid 1990s a group of county sheriffs and county commissioners worked together to make the system as 'uniform' as possible between the counties.

# Permit System History

---

- The permit system started as a self-issue paper permit 'on your honor' system.
- In 2010 the online ePermit Management System was built.
- ePermits AND Self-Issue Paper Permits were issued for the next five years.

# Permit System History

---

- 2015 – Discontinued paper permits
- 2016 – Added ACH payment option for users and county payments
- 2016 – WDEA voted to expand to all ND counties
  - ByLaws Rewritten to give all member counties a voice
  - HB 1320 Signed into Law
    - 5 day Signage Waiver
    - Township Participation
- 2017 – Rebranded to **LoadPass Permits**
  - Formerly the ND Uniform County Permit System



# Why LoadPass Permits?

---

- Provides uniformity across county lines for both local governments and industry
- Single point for industry to obtain permits for multiple local governments
- Manage traffic using color-coded LoadPass user-friendly Dashboard





# LoadPass Permits – Membership Benefits

---

- Retain control of local roads
- Increase revenues for road maintenance
- Reduce office and telephone traffic
- Receive funds via ACH into account each month
- Prepare for future projects
  - Pipelines
  - Wind Farms
  - Energy Industry
  - Construction
  - Agriculture



# Member Responsibilities

---

- Must provide designated contact person during business hours to respond to permit requests within reasonable time one to two hours.
- Must provide designated contact person during non-business hours to respond to permit requests – once in evening and once or twice per weekend day if a request is received.

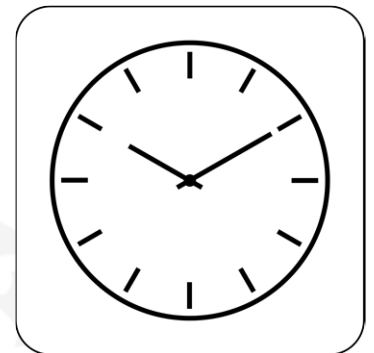

# Membership Fees

---

- Initial Fee - \$1,500
  - Covers Initial Setup and Training
- Subsequent Years – Based on number of permits sold the prior year

0 - 500	\$ 500
501-1,500	\$ 750
1,501-3,000	\$ 1,250
3,001-5,000	\$ 1,500
5,001- over	\$ 2,000

# Types of Permits

---

- Trip Permit – Graduated Fee Schedule
- Restricted Road Permit - \$5 per ton per mile over restricted weight plus \$1 per ton per mile for each axle over the restricted axle weight
- Xcess Permit - assesses a \$5 per ton per mile fee on loads over 150,000 lbs.

# Types of Permits –

---

- Harvest Permit – 10% overweight
  - similar to the state's Harvest Permit
  - \$50 per 30 days per county
- Wintertime Permit – 10% overweight
  - similar to the state's Wintertime Permit
  - \$50 per 30 days per county
- Annual Over-Width Permit –
  - \$150 annually - per unit, per county
- Frost Law Permit
  - Allowed to drive 7 Ton / Axle on 6 Ton Road
  - Optional per county
  - \$1,000 per unit per county



## Total Number of Permits Sold on Behalf of all Members Annually 2007-2019

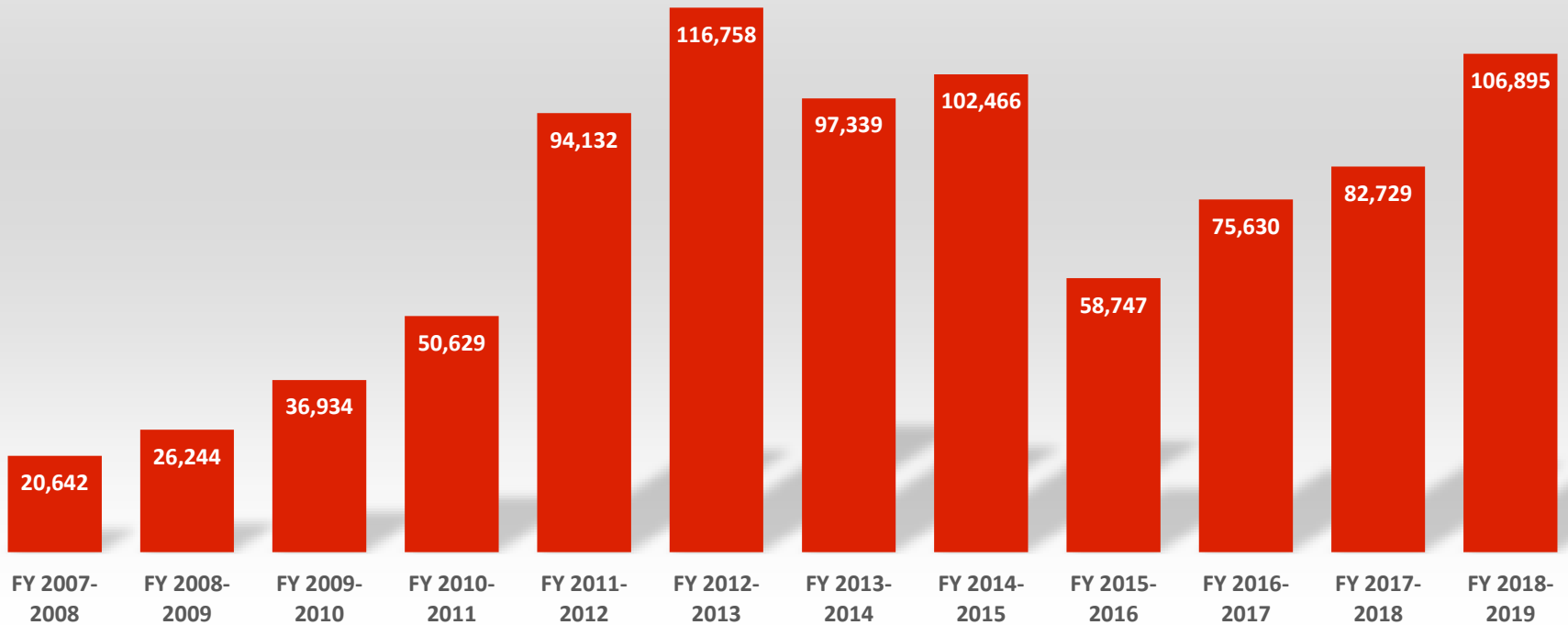

# Permit Fees Collected Annually – County Sampling

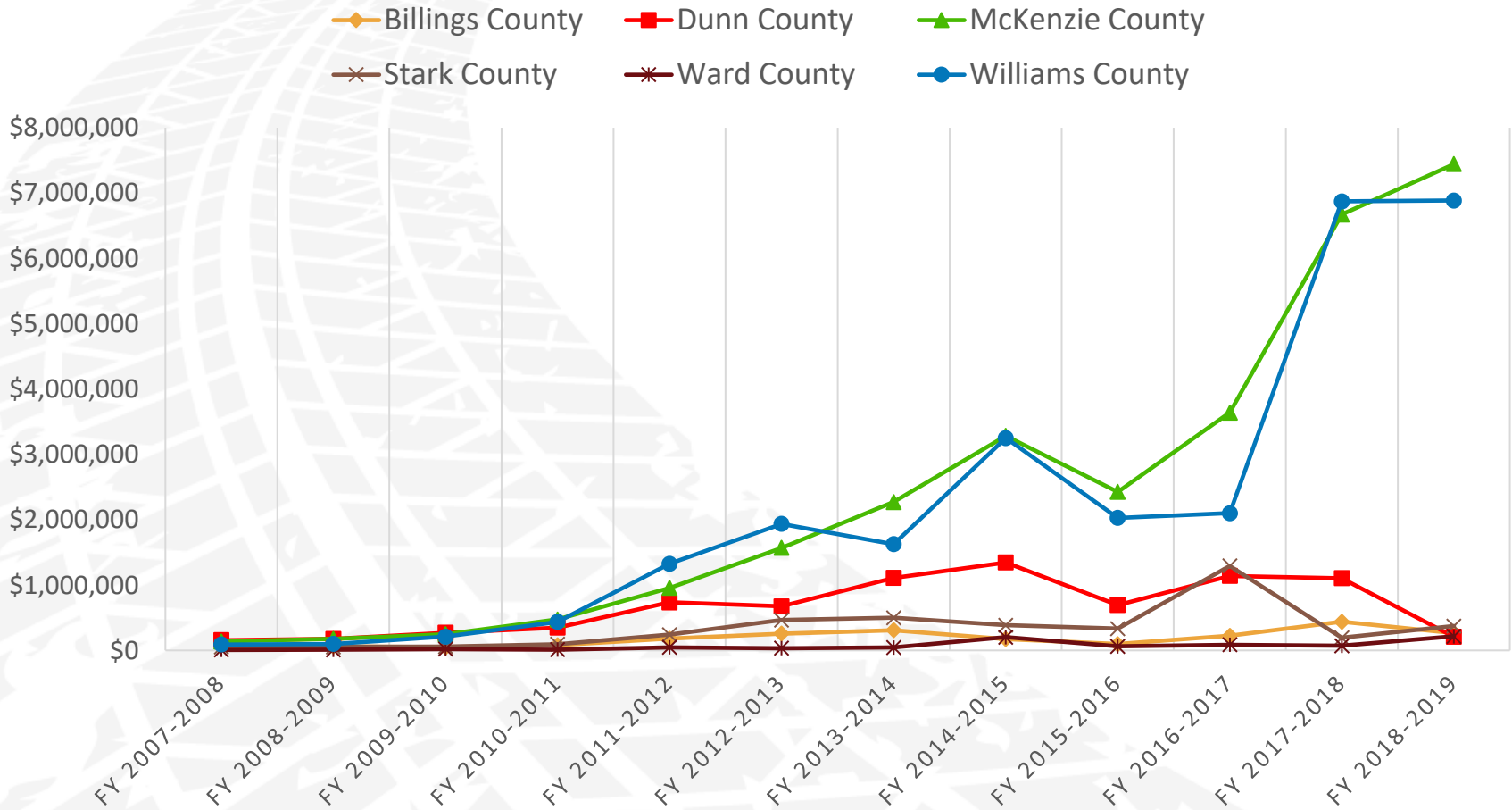



# Road Status Communication System

---

- In 2012, the LoadPass Communication System was implemented.
  - Counties/Cities/Townships can post load restrictions, road closings, restrictions lifted, construction projects, etc., and the notification will be emailed or texted in real time to anyone registered to receive the notifications.
  - We currently have over 13,000 users registered to receive text notifications and over 13,000 registered to receive email notifications.

# Enhancements Developed

---

- Routable Road Network
  - Phase I
    - Routable Road Map and Static Restriction Map – Completed July, 2018
  - Phase II
    - Addition of the Road Restrictions to the system – interfaced with LoadPass System. Released August 20, 2019

# LoadPass Routable Map

## LoadPass Routing Application

Weight

pounds

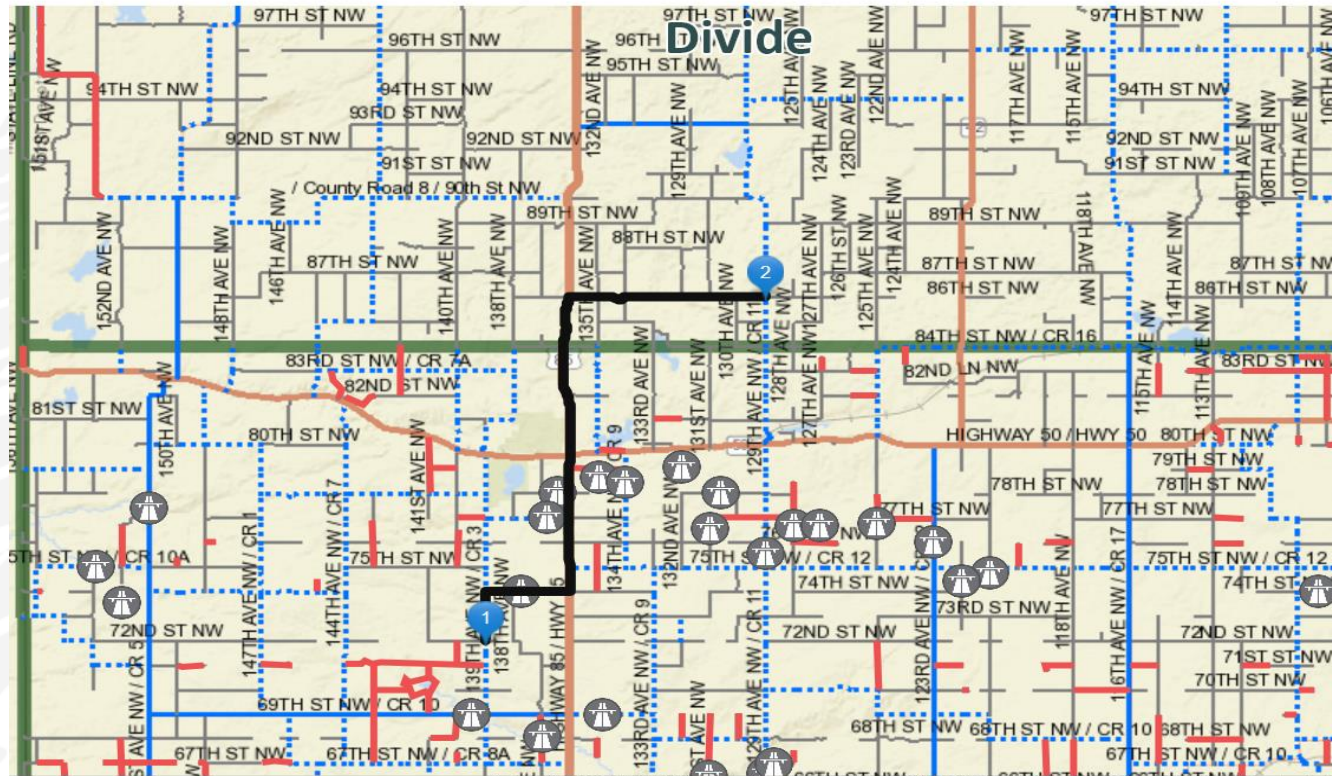

## Directions

24.18 miles

1. Start at 72nd St, Williston, North Dakota, 58801\_1004
2. Go northeast on 72ND ST NW toward 139TH AVE NW  
0.07 mi
3. Turn left on 139TH AVE NW  
1.93 mi · 3 min
4. Turn right on 74TH ST NW  
2.99 mi · 4 min
5. Turn left on



# Enhancements being Developed

---

- Law Enforcement App
  - Quick lookup for permit verification and reporting
- Administration App
  - Quick access for review and approval
- End User App
  - Access to permit
  - Potential Navigation

# Contact Information

---

- Janet Sanford - 701-770-1632  
[janet@ndteamworks.com](mailto:janet@ndteamworks.com)
- Brent Bogar - 701-770-3048  
[bcbogar@jadestoneconsulting.com](mailto:bcbogar@jadestoneconsulting.com)
- [www.loadpasspermits.com](http://www.loadpasspermits.com)