

RURAL LEADERS FOR ECONOMIC MOBILITY *INFORMATION SESSION*

National Association of Counties Research Foundation
April 3, 2024

HOUSEKEEPING



Attendees are automatically placed on mute.



We are recording this meeting and will post the recording and the slides on our website.



Submit your questions via the “Q&A” function.

NACO'S ECONOMIC MOBILITY WORK



- In partnership with the Bill & Melinda Gates Foundation, NACO's [Economic Mobility Leadership Network](#) met virtually and in-person from 2019 – 2023, examining the interconnected issues that comprise economic mobility.
- As a continuation of this work, NACO has established the new [Rural Leaders for Economic Mobility](#) initiative to delve into rural-specific solutions for moving individuals and families out of poverty.

ABOUT RLEM

Rural Leaders for Economic Mobility (RLEM) is a NACo initiative for county leaders committed to **moving individuals and families out of poverty.**

APPLY TODAY for the 10-county cohort!

NACo is seeking applications from **county teams** interested in participating in **free technical assistance and peer learning events**. Applications should identify one:

- Elected official
- Community member

Applications due:

**APRIL
22**

WHO SHOULD APPLY?

From each county/parish/borough under 50,000 people,
2 core leaders:



Elected official

e.g., Commissioner, supervisor, police juror, executive, council/assembly member



Local government employee or community member

*e.g., a county chief of staff, administrative officer, department head
a nonprofit leader, a community college president, industry leader,
or representatives from a chamber of commerce/business
association, a development organization, or regional planning agency*

COHORT COMPOSITION



Across 10 counties, **20 total core leaders:**



participating in technical assistance and peer learning.

COMMITTMENTS

- 18-month commitment (from June 2024 through Fall 2025) to participate in:

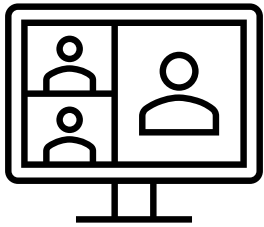

Monthly
virtual
check-ins

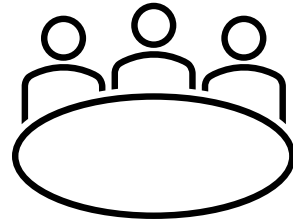

3 in-person
NACo
conferences

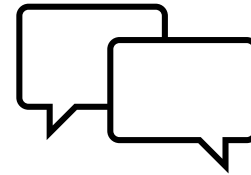

3 **in-person peer**
exchanges in
RLEM member
counties

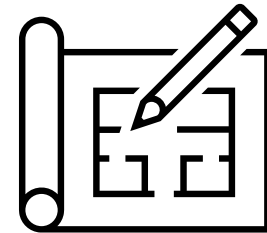

Developing a
county-specific
action plan for
economic mobility
and community
engagement



APPLICATION QUESTIONS

(see application)

SCORING AND SELECTION

Overall considerations include:

- Authority, responsibility and commitment
- Geographic, economic and demographic diversity
- Strength of partnership of team members
- Level of economic vulnerability, including for historically marginalized communities

Applications will be evaluated by:



PARTNER ORGANIZATIONS

- Results for America
- Urban Institute
- Opportunity Insights



LEADERSHIP ADVISORY COUNCIL

- 10 previous members of the Economic Mobility Leadership Network



NACo is accepting applications for our **Rural Leaders for Economic Mobility (RLEM) technical assistance program** to move families out of poverty!

APPLY

BY **MONDAY, APRIL 22**

THANK YOU!

Liz Ward
National Association of Counties (NACo)
Program Manager, Resilient Economies and Communities

eward@naco.org | 202-942-4265